



Worksheet 2

Buried Treasure

Writing Directions

'I headed straight for the church that I thought could be the one shown on the map. Once there, I turned north, facing the way the map had been drawn. I followed the map intently, hurrying three blocks east, one south, two west, then half a block south to the tallest tree in the street.'

The author of the story follows directions on a map in the pursuit of buried treasure with unexpected results!

Write your own set of instructions for a classmate to follow to locate a 'treasure'. (The treasure might be a lolly, a kind note or a small gift!)

Locate the four cardinal points in your classroom (north, south, east and west) and draw a simple map. For example:

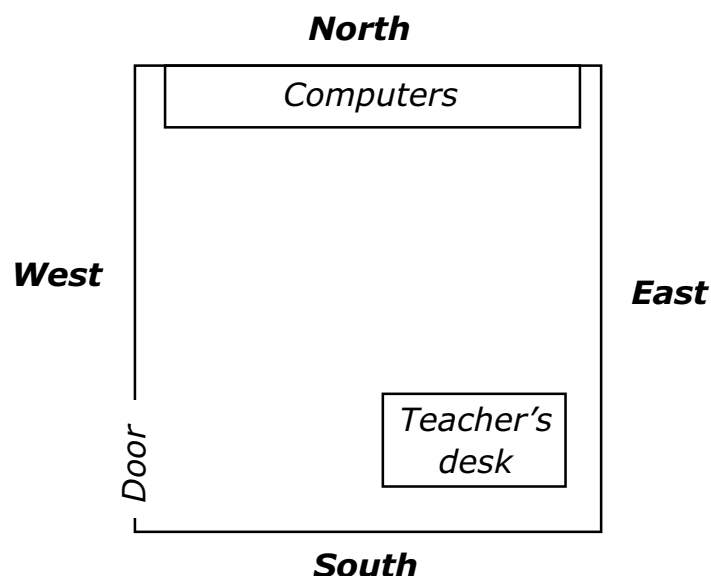

Your instructions could include directions like this:

Start at the teacher's desk and face west. Take two steps forward then turn north. Take five steps forward and turn east.

Continue until your directions take your classmate to the hidden 'treasure.'
Good luck!